

MIXING CONSOLE OWNERS MANUAL

General Specification

0 dBu=0.775 Vrms, 0 dBV=1 Vrms

If no pin is specified, all pins will be set to the nominal position.

(nominal position adjusted to 10 dB below maximum) Signal generator output impedance

(Rs)=100 ohm, output load impedance =100k ohm (TRS phone type output)

	INPUT	OUTPUT	CHANNEL	
			MIC	LINE
GAIN (0dBu)	GAIN (0dBu)		2~51	-22~32
	PHONES OUT	MAX (ALL MAX)	74	54
		0dB (GAIN Control at 0dB)	0	2
	MAIN OUT	MAX (ALL MAX)	74	54
		0dB (GAIN Control at 0dB)	0	2
REC IN	LEVEL MAX (GAIN Control at 0dB)	10		
Signal to Noise Ratio	MAIN OUT	85	81	
	PHONES OUT	85	80	
Noise (Control at MIN)	PHONES OUT (Fader at 0dB)	85	-80~90	
	MAIN OUT (Fader at 0dB)	96	-80~90	
	MAIN OUT (Fader at MIN)	94	-80~90	
	LOW CUT	100Hz		

The contents of this manual are the latest technical specifications at the time of printing.

As the product will continue to improve, it is possible that the specifications in this manual are not in conformity with your product specifications.

Please go to the website to download the latest version of the manual. Technical specifications, equipment or accessories may vary from region to region, so please check with your local distributor if you have any questions.

Recording/Webcast/Mini Mixer

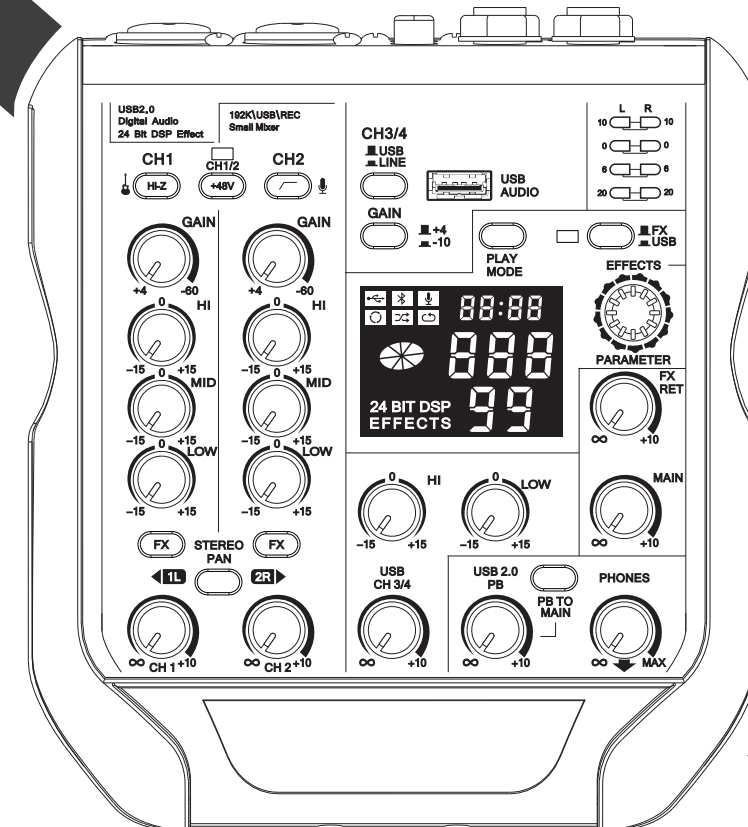

* the contents of this manual are the latest technical specifications at the time of publication.

PRECAUTIONS

PLEASE READ CAREFULLY BEFORE PROCEEDING

Please keep this manual in a safe place for future reference.

WARNING

Always follow the basic precautions listed below to avoid the possibility of serious injury or even death from electrical shock, short-circuiting, damages, fire or other hazards. These precautions include, but are not limited to, the following:

Do not open

- This device contains no user-serviceable parts. Do not open the device or attempt to disassemble the internal parts or modify them in any way. If it should appear to be malfunctioning, discontinue use immediately and have it inspected by qualified service personnel.

Water warning

- Do not expose the device to rain, use it near water or in damp or wet conditions, or place on it any containers (such as vases, bottles or glasses) containing liquids which might spill into any openings. If any liquid such as water seeps into the device, turn off the power immediately and disconnect the USB cable from the computer. Then have the device inspected by qualified service personnel.
- Never insert or remove a USB cable with wet hands.

Fire warning

- Do not put burning items, such as candles, on the unit. A burning item may fall over and cause a fire.

If you notice any abnormality

- When one of the following problems occur, immediately turn off the power switch and disconnect the USB cable from the computer. Then have the device inspected service personnel.
 - The USB cable becomes frayed or damaged.
 - It emits unusual smells or smoke.
 - Some object has been dropped into the device.
 - There is a sudden loss of sound during use of the device.

- If this device should be dropped or damaged, immediately turn off the power switch, disconnect the USB cable from the computer, and have the device inspected by qualified service personnel.

CAUTION

Always follow the basic precautions listed below to avoid the possibility of physical injury to you or others, or damage to the device or other property. These precautions include, but are not limited to, the following:

Location

- Do not place the device in an unstable position where it might accidentally fall over.
- Do not place the device in a location where it may come into contact with corrosive gases or salt air. Doing so may result in malfunction.
- Before moving the device, remove all connected cables.

Connections

- Before connecting the device to other devices, turn off the power for all devices. Before turning the power on or off for all devices, set all volume levels to minimum.

Maintenance

- Remove the USB cable from a computer when cleaning the device.

Handling caution

- Do not insert your fingers or hands in any gaps or openings on the device.
- Avoid inserting or dropping foreign objects (paper, plastic, metal, etc.) into any gaps or openings on the device. If this happens, turn off the power immediately and disconnect the USB cable from the computer. Then have the device inspected by qualified service personnel.
- Do not rest your weight on the device or place heavy objects on it, and avoid use excessive force on the buttons, switches or connectors
- Do not use speakers or headphones for a long period of time at a high or uncomfortable volume level, since this can cause permanent hearing loss. If you experience any hearing loss or ringing in the ears, consult a physician.

cannot be held responsible for damage caused by improper use or modifications to the device, or data that is lost or destroyed.

NOTICE

To avoid the possibility of malfunction/ damage to the product, damage to data, or damage to other property, follow the notices below.

■ Handling and maintenance

- Do not use the device in the vicinity of a TV, radio, stereo equipment, mobile phone, or other electric devices. Otherwise, the device, TV, or radio may generate noise.
- Do not expose the device to excessive dust or vibration, or extreme cold or heat (such as in direct sunlight, near a heater, or in a car during the day), in order to prevent the possibility of panel disfiguration, unstable operation, or damage to the internal components.
- Do not place vinyl, plastic or rubber objects on the device, since this might discolor the panel.
- When cleaning the device, use a dry and soft cloth. Do not use paint thinners, solvents, cleaning fluids, or chemical-impregnated wiping cloths.
- Condensation can occur in the device due to rapid, drastic changes in ambient temperature—when the device is moved from one location to another, or air conditioning is turned on or off, for example. Using the device while condensation is present can cause damage. If there is reason to believe that condensation might have occurred, leave the device for several hours without turning on the power until the condensation has completely dried out.
- Avoid setting all equalizer controls and faders to their maximum. Depending on the condition of the connected devices, doing so may cause feedback and may damage the speakers.
- Do not apply oil, grease, or contact cleaner to the faders. Doing so may cause problems with electrical contact or fader motion.
- When turning on the AC power in your audio system, always turn on the power amplifier LAST, to avoid speaker damage. When turning the power off, the power amplifier should be turned off FIRST for the same reason.
- When the device no working a long time, please set the switch to the standby position.

■ Connectors

XLR-type connectors are wired as follows (IEC60268 standard): pin 1: ground, pin 2: hot (+), and pin 3: cold (-).

Information

■ About this manual

- The illustrations as shown in this manual are for instructional purposes only.
- Steinberg and Cubase are registered trademarks of Steinberg Media Technologies GmbH.
- The company names and product names in this manual are the trademarks or registered trademarks of their respective companies.

Welcome

Thank you for purchasing the Mixing Console. Please read this manual thoroughly to get the most out of the product and ensure long-term, trouble-free use.
After reading this manual, keep it readily available for future reference.
For the remainder of this manual, the word "mixer" is used instead of "Mixing Console."

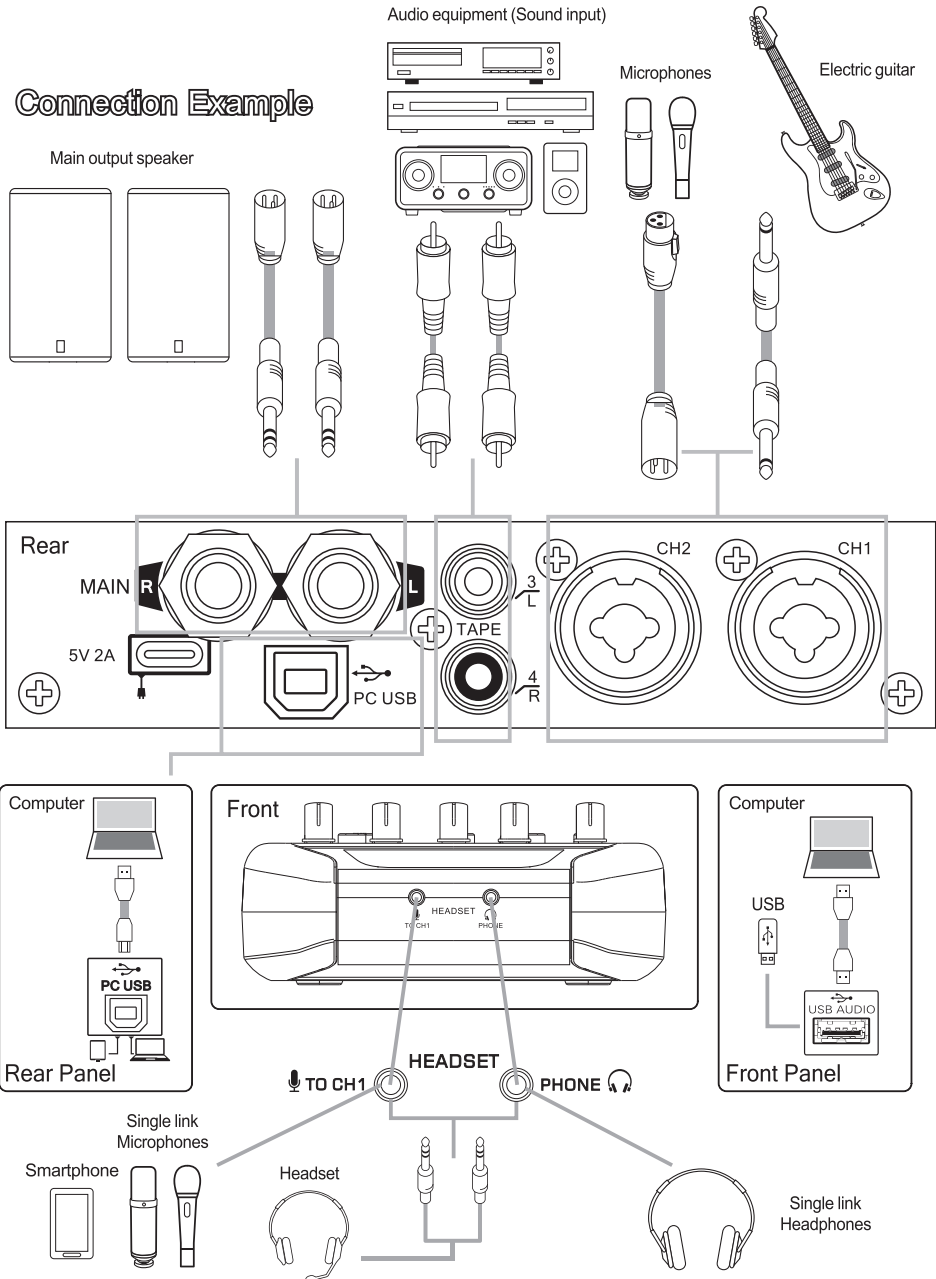

Main Features

Multi-purpose mixer with audio interface, ideal equipment for small performance and network broadcast.

- USB recording.
- the high quality loop playback function makes the performance and network broadcast more convenient.
- super amplifier provides high precision sound.
- bluetooth connection.

1. Mixer Basics: Where Your Sound Goes

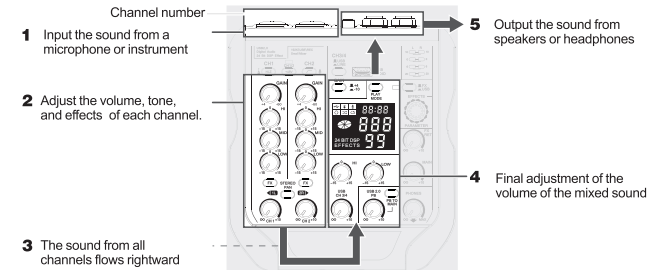

2. Basic operation: power connection

1. Make sure that all switches on the device are not turned on and TYPE-C data line of the rear panel power is not inserted.
2. Connect the attached TYPE-C data line.
 - A. Align the type-C data cable plug with the device back panel interface and insert it.
 - B. The TYPE-C data cable is connected to the USB power adapter.
 - C. Plug the power adapter into the standard [-AC 100-240 50Hz/60Hz] power socket.

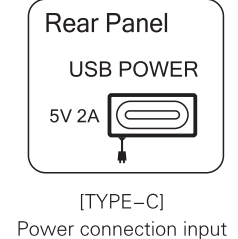

Note: if capacitive microphone is used, please turn on the switch of ()48V phantom power supply.

Controls and Functions

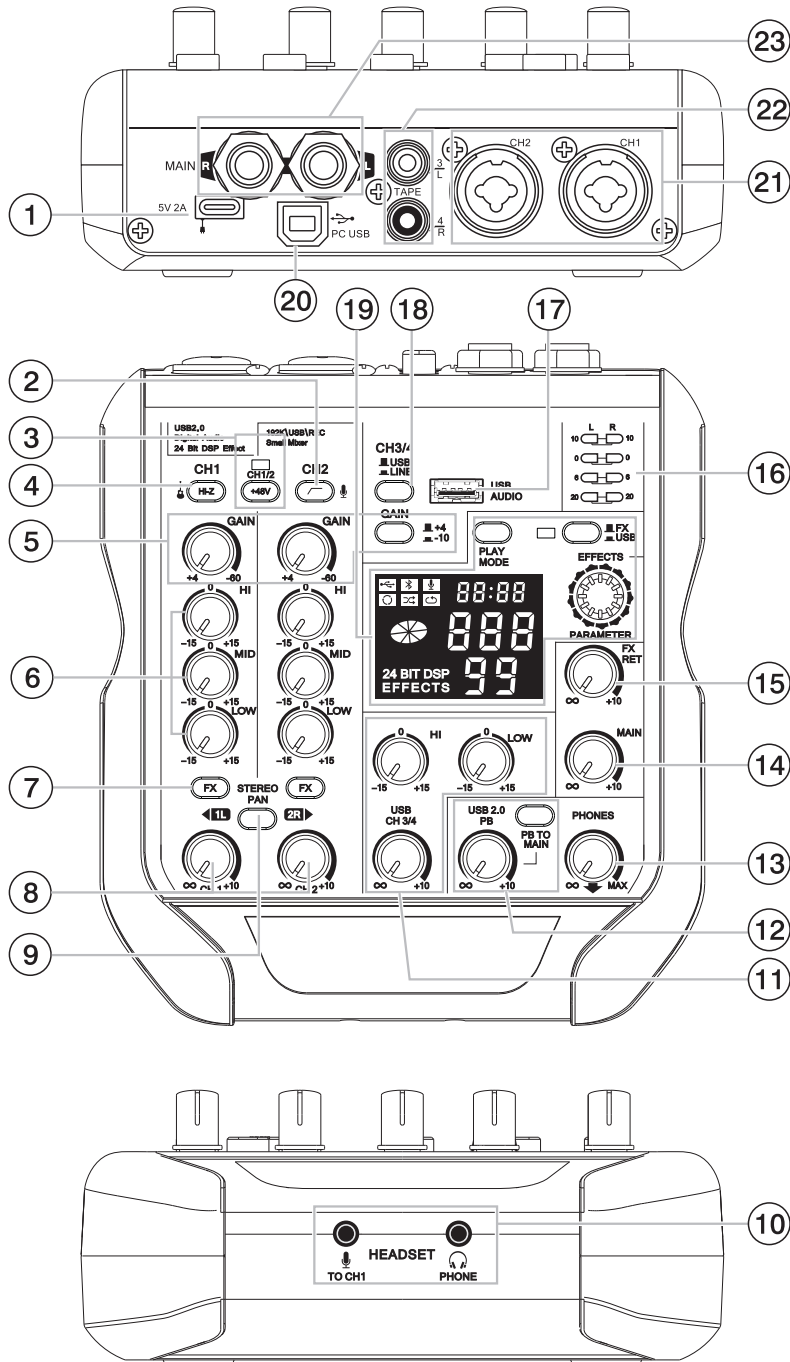

1.[TYPE-C]Power input socket

It is used to connect the USB power adapter and type-C data cable for power supply of the mixer.

Note

- Read carefully the safety precautions for the USB power adapter and type-C data cable you are using.
- USB power adapter and TYPE-C data line Voltage standard: Output voltage: 4.8V to 5.2V
Output current: 3A or higher

2.LOW CUT Buttons

This switch will apply a high-pass filter that attenuates frequencies below 100Hz in the signal by a slope of 12dB/octave.

3.PHANTOM/+48V LED(CH1/2)

When this switch is turned on (■), the [+48V] LED lights and DC +48 V phantom power is supplied to the XLR plug on MIC/LINE input jack (21). Turn this switch on when using a phantom powered condenser microphone.

NOTICE

Be sure to leave this switch off (■) if you do not need phantom power.

Follow the important precautions below, in order to prevent noise and possible damage to external devices as well as the mixer if you turn this switch on (■).

1. Be sure to leave this switch off (■) when you connect a device that does not support phantom power to channel 1.
2. Make sure to turn this switch off (■) when connecting/disconnecting a cable to/from channel 1.
3. Slide the fader on channel 1 to minimum before turning this switch on (■)/off (■).

4.HI-Z(CH1)

To connect a guitar directly to the mixer without using a DI Box, press this switch in first; then connect the output from the guitar to the channel 1" TRS input. The input impedance is optimized for direct connection and high-frequency fidelity is assured. In the out position, the channel 1" TRS input becomes a line input just like the other mono line input.

To use guitars or other instruments on other channels, you will need to use an external DI box first. Without the DI box-or if this switch is not pressed in-guitars may sound dull and muddy.

5.GAIN Knob

The sensitivity of the channel input signal can be adjusted. (For gain matching, the stereo inputs feature a GAIN switch which selects between +4 dBu and -10 dBV.)

6.EQ Knob

Use [HIGH], [MID] and [LOW] knobs to adjust sound quality. If you don't need to adjust sound quality, set the knob to "0" (flat).

7.FX Buttons

These buttons turn on the effects on channels, add a natural spaciousness to the sound. The default settings have reverb turned off.

8.LEVEL Knob

Used to adjust the level of the channel signal.

Note: To minimize noise, adjust the knobs on unused channels to a minimum.

9.LINK Stereo Pan Switch

With this switch out, each mono channel feeds both the left and right sides of the main mix equally.
For example:

- Playing a mono source: If you talk into a microphone connected to input 1, your sweet tones will be heard in both the left and right loudspeakers.
- With this switch pressed in, channel 1 will play only in the left side of the main mix, and channel 2 will play in the right side.

For example:

Recording a stereo source: If you have a stereo microphone connected to the mic inputs, or if you are playing a stereo source into the line inputs, each side of the source can be recorded discretely onto a recorder connected to the main outputs.

The pan switch does not affect the other channels.

10.[HEADSET]microphone[]input jack

For connecting to the microphone for your headset. The audio input here is sent to channel 1.

[HEADSET]headphones[]output jack

For connecting to the headphone for your headset.

11.CH 3/4 CONTROL Knob and USB CONTROL Knob

Please refer to the function description and control of ⑥ and ⑧.

12.PC USB 2.0 PLAY BACK Knob

Used to adjust the volume of the input signal connected from the [USB 2.0] port.

PLAY BACK TO MAIN Buttons

This switch () is used to enter signals via USB.If the signal is (), it will be sent to the MAIN channel

13.PHONE Knob

Used to adjust the volume of the output of the earphone [] connected to the socket.

14.MAIN KNOB

Used to adjust the signal level output to the [MAIN] socket.

15.FX RET Knob

Used to adjust the effect level sent from the internal effector to the bus.

16.Level meter LED

The L and R meters show the level (volume) of the output signal from the [MAIN OUT] socket in 4 levels."+10", "0", "-6", "-20" dB.

If the continues to glow red, turn the [MAIN LEVEL] knob to the left to lower the volume.

17.USB

used to connect to USB flash drive

Supported :MP3 or WAV/WMA/FLAC or as a USB audio device

18.USB / CH3/4 Switch Buttons

For input signal switching between [USB] and [CH3/4].

19.Effect Module

A. PLAY MODE Buttons
Used to switch between various functional modes.

B. FX/USB Switch Buttons
Used between the PARAMETER encoder and the type of player and effect Control switch.
(When USB is selected, the LED to the button will light up)

C. DISPLAY

- 1.Function Display
- 2.Display the running status or bluetooth connection status
- 3.song time display
- 4.song number display
- 5.effect types(please refer to the list of effects on the left)

DIGITAL EFFECTS	27-29 GatedReverb
00-01 Ambience	30-33 Chorus
02-04 Bathroom	34-39 ChorusReverb
05-10 Room	40-41 Phaser
11-15 Plate	42-43 PhaserReverb
16-18 Spring	44-49 Flanger
19-24 Hall	50-52 FlangerReverb
25 Warehouse	53-59 Rotary
26 Cathedral	60-99 Delay

PARAMETER

[FX/USB] Switch Buttons

1.DISPLAY 2.Rotary Knob

Effect → Add/right → Effect

Turn to select the effect type and it will take effect automatically.

1.DISPLAY 2.Rotary Knob

According to the music → Add/right → According to the music

In the play → Rotate the selected track and press Confirm the current selection and play. → In the play

Operational control instructions

- PLAY MODE (touch the button)** : Short press: pre-selected MODE, corresponding MODE ICONS flash display, successively as Usb flash disk, Bluetooth, recording, Sequential play, random play, single loop (short press the PARAMETER key to confirm switch).
- PLAY MODE (touch the button)** : Long press: 1. Under the recording MODE, stop recording, enter the recording file MODE. 2. In the non-recording mode, you can quickly enter the recording file mode.
- PARAMETER (encoder key)** : Short press: 1. Control operation or suspension (including playing and recording). 2. Mode icon flashing, confirm the switch current scintillation display mode. 3. The rotation encoder to primary play songs, the corresponding songs to confirm.
- PARAMETER (encoder key)** : Long press: 1. Control stop (including playing and recording). 2. When recording has stopped, but into play the recording file mode. 3. In bluetooth mode, can disconnect the bluetooth connection.
- Encoder**: 1. When playing usb flash drive, pre-select the playlist. 2. Switch up/down when bluetooth and recording files are playing.
- When playing the recording file, display the U disk and the recording icon at the same time for indication.

20.PC USB 2.0

When connected to a computer, Data can be sent between the mixer and computer.
(This signal is not affected by the [MAIN].)

21.MIC/LINE

For connecting to a microphone, an instrument, or an audiodevice. These jacks support both XLR and phone plugs.



22.TAPE

Rec Input: Only TAPE channels use unbalanced RCA interface (TAPE INPUT) to connect stereo line signals, such as TAPE recorder, CD player, MP3 player, TV sound, etc.
Stereo Input: For connecting to line-level devices such as an electric keyboard or an audio device.

23.MAIN OUT

These are balanced XLR and TRS output jacks that output the mixed stereo signal. They output the signal adjusted by the STEREO master fader.
Connect these jacks to the power amplifier that drive your main speakers.

◆ Computer Connection Settings ◆

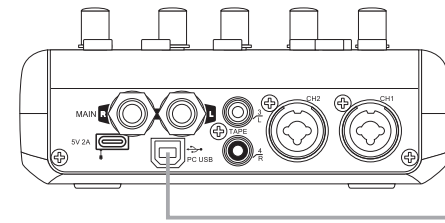

OTG
PC USB
1.9 sampling frequency

When it connecting, the default volume is 100%, please reduce to 60% in the following step.

PHONE [USB] 100%

Right Click

Click the volume synthesizer (M)
Broadcast equipment (P)
Recording equipment (R)
Sound (S)
Volume control option (V)

Click the volume synthesizer (M)
Broadcast equipment (P)
Recording equipment (R)
Sound (S)
Volume control option (V)